

## Overhead Conveyor Bearings



These bearings are designed for use in over head conveyor systems. They are constructed using fully machined raceways made from case hardened steels.

Bearings can be supplied with either caged or full complement ball arrangement.

Sealed and shielded bearings are normally greased for life. Open types are not normally greased. Other Lubricants are available on request.

\* Sealed for bearing life.

Finish:

Self Colour, Zinc Plated or Blacked.

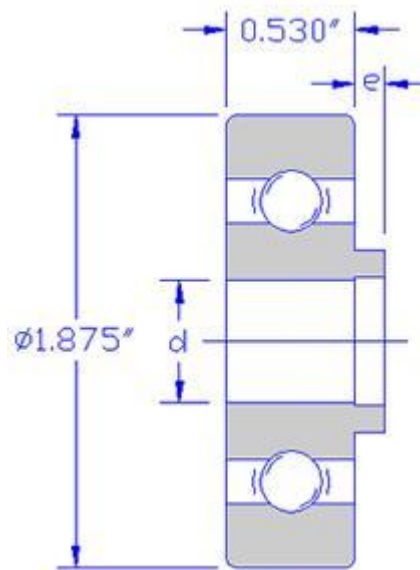

Part No.	d	e	Type	Finish	Shield	Dynamic Load (kgs)
<b>B2000</b>	0.500"	0.125"	STEEL CAGE	SELF COLOUR	-	200
<b>B2000SG</b>	0.500"	0.028"	STEEL CAGE	BLACK OXIDE	-	200
<b>B2000DC-SN</b>	0.500"	0.125"	FULL COMPLEMENT	ZINC PLATE	-	200
<b>B2000DC-MN</b>	0.472"	0.335"	FULL COMPLEMENT	SELF COLOUR	-	200

<b>B2000DC-LN</b>	0.500"	0.500"	FULL COMPLEMENT	ZINC PLATE	-	200
<b>B2000DC-2S*</b>	0.500"	0.125"	FULL COMPLEMENT	SELF COLOUR	STEEL	200
<b>B2000DC-2S- LN*</b>	0.500"	0.500"	FULL COMPLEMENT	SELF COLOUR	STEEL	200
<b>B2000-2PSZ*</b>	0.500"	0.125"	ACETAL CAGE	ZINC PLATE	RUBBER	200
<b>B20002S*</b>	0.500"	0.125"	STEEL CAGE	SELF COLOUR	STEEL	200
<b>B2000PCT</b>	0.500"	0.125"	ACETAL CAGE	SELF COLOUR	-	200
<b>B2000LB</b>	0.500"	0.504"	STEEL CAGE	SELF COLOUR	-	200